

# Hypertherm®

## MAX200 Machine torch parts

### MAX200 consumables



MAX200



128380 - Standard body - 2" sleeve



128365 - Stainless steel body

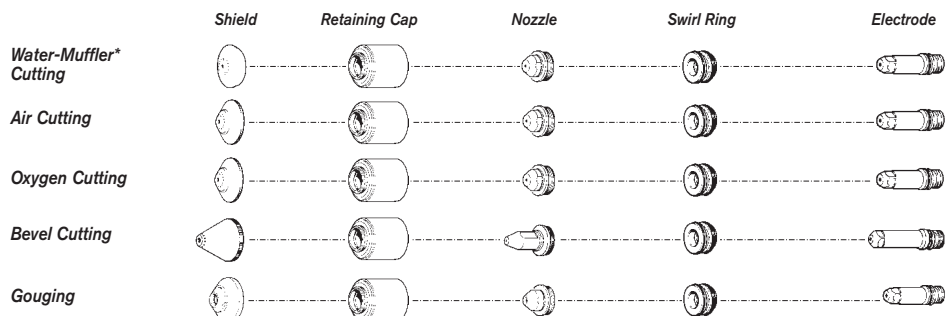

APPLICATION	PLASMA GAS	CONSUMABLE DESCRIPTION	PART NUMBER				QUANTITY PER PACKAGE
			200 AMP BEVEL	200 AMPS	100 AMPS	40 AMPS	
CUTTING	Oxygen	Electrode-Standard	120258	220021	120547	-----	5
		Electrode-SilverPlus	-----	220083	-----	-----	-----
		Swirl Ring	120833	120604	020617	-----	1
		Nozzle	120259	020605	020616	-----	5
		Retaining Cap	020423	020423	020423	-----	1
		Retaining Cap w/IHS**	120837	120837	120837	-----	1
		Shield	120260	020424	020448	-----	1
		(Water Muffler*) Shield	-----	020566	020618	-----	1
	Air	Electrode	-----	220021	120547	120667	5
		Swirl Ring	-----	020607	020607	020613	1
		Nozzle	-----	020608	020611	020689	5
		Retaining Cap	-----	020423	020423	020423	1
		Retaining Cap w/IHS**	-----	120837	120837	120837	1
		Shield	-----	020424	020448	020688	1
		(Water Muffler*) Shield	-----	020566	020618	-----	1
		Argon/Hydrogen	Electrode	-----	020415	020415	-----
	Swirl Ring		-----	020607	020607	-----	1
	Nozzle		-----	020608	020611	-----	5
	Retaining Cap		-----	020423	020423	-----	1
	Retaining Cap w/IHS**		-----	120837	120837	-----	1
Shield	-----		020602	020448	-----	1	
Nitrogen	Electrode		-----	020415	-----	-----	5
	Swirl Ring		-----	020607	-----	-----	1
	Nozzle	-----	020608	-----	-----	5	
	Retaining Cap	-----	020423	-----	-----	1	
	Retaining Cap w/IHS**	-----	120837	-----	-----	1	
	Shield	-----	020424	-----	-----	1	
	(Water Muffler*) Shield	-----	020566	-----	-----	1	
	GOUGING	Air	Electrode	-----	220021	-----	-----
Swirl Ring			-----	020607	-----	-----	1
Nozzle			-----	020615	-----	-----	5
Retaining Cap			-----	020423	-----	-----	1
Shield			-----	020485	-----	-----	1
Argon/Hydrogen		Electrode	-----	020415	-----	-----	5
		Swirl Ring	-----	020607	-----	-----	1
		Nozzle	-----	020615	-----	-----	5
		Retaining Cap	-----	020423	-----	-----	1
		Shield	-----	020485	-----	-----	1

\* Water muffler cannot be used with 2" 120356 stainless steel torch or with ohmic height sensing.

\*\* IHS = Initial Height Sensing

**Genuine Hypertherm Consumables**

The only way to ensure maximum performance

### WARNING

\* In countries following CE standards, unshielded consumables may only be used in mechanized torch applications.

Unshielded consumables: maintain torch-to-work distance of approximately 3/16" (4.8 mm).

## MAX200 machine torch assembly

128380 - Standard body - 2" sleeve

128364 - Optional body - 1 3/4" sleeve

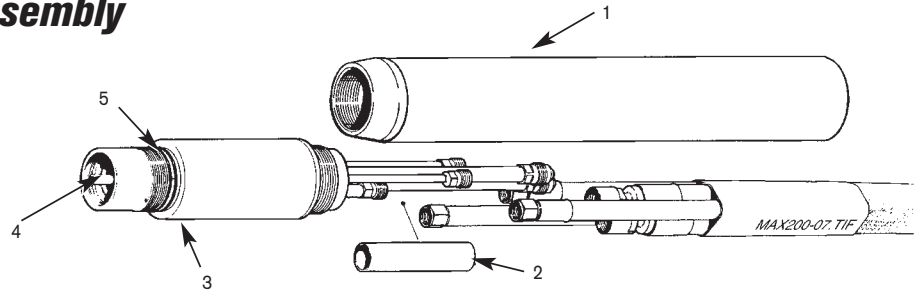

128380 - Standard body - 2" sleeve

ITEM NUMBER	STANDARD BODY (2") PART NO.	DESCRIPTION	OPTIONAL BODY (1 3/4") PART NO.
	128380^	MAX200 Machine Torch Assembly	128364
	028383*	Leads, Torch, 50' / 15.2 m	028383
	028384*	Leads, Torch, 25' / 7.6 m	028384
1	120894	Torch Mounting Sleeve	020431
2	020536	Lead Insulator, 5/16 x 2.5"	020536
3	120584	MAX200/HT2000 Machine Torch Main Body	120584
4	020963	Water Tube, Electrode Cooling, Standard	020963
4	120257	Water Tube, Electrode Cooling, Extended	120257
5	044027	O-Ring: Buna 70 Duro 1.301 x .070	044027^

^ Assembly includes consumables

\* Other lead lengths available.

Consult your Operating Manual.

## MAX200 machine torch assembly

128365 - Stainless steel body

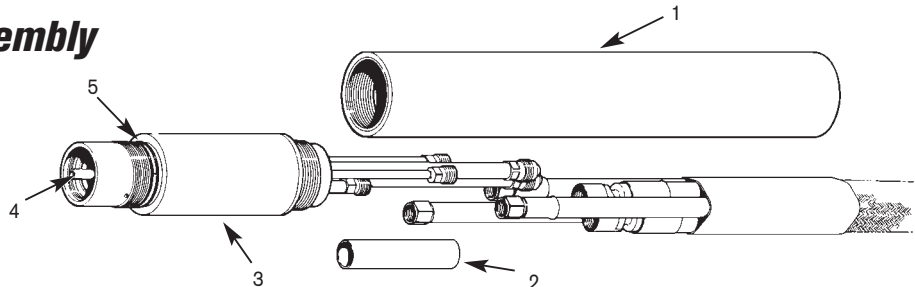

128365 - Stainless steel body

ITEM NUMBER	PART NO.	DESCRIPTION
	128365^	MAX200 Machine Torch Assembly
	120356	MAX200/HT2000 Machine Torch Main Body
	028384*	Leads, Torch, 50' / 15.2 m
1	020041	Torch Mounting Sleeve
2	020536	Lead Insulator, 5/16 x 2.5"
3	028383*	Leads, Torch, 25' / 7.6 m
4	020963	Water Tube, Electrode Cooling, Standard
4	120257	Water Tube, Electrode Cooling, Extended
5	044027	O-Ring: Buna 70 Duro 1.301 x .070

^ Assembly includes consumables

\* Other lead lengths available.

Consult your Operating Manual.

Hypertherm, MAX and PAC are trademarks of Hypertherm, Inc. and may be registered in the United States and/or other countries.

# Hypertherm®

The world leader in  
plasma cutting technology™

www.hypertherm.com

Hypertherm, Inc. USA 603-643-3441 Tel 603-643-5352 Fax consumable.info@hypertherm.com

Hypertherm Automation, LLC USA 603-298-7970 Tel 603-298-7977 Fax info@hyperthermautomation.com

Hypertherm Plasmatechnik, GmbH Deutschland 49 6181 58 2100 Tel 49 6181 58 2134 Fax HTDeutschland.info@hypertherm.com

Hypertherm (S) Pte Ltd Singapore 65 6 841 2489 Tel 6 65 841 2490 Fax HTSingapore.info@hypertherm.com

Hypertherm UK, Ltd England 44 1928 579 074 Tel 44 1928 579 604 Fax HTUK.info@hypertherm.com

France 00 800 3324 9737 Tél 00 800 4973 7329 Fax HTFrance.info@hypertherm.com

Hypertherm S.r.l. Italia 39 02 725 46 312 Tel 39 02 725 46 400 Fax HTItalia.info@hypertherm.com

Hypertherm Europe B.V. Nederland 31 165 59 69 08 Tel 31 165 59 69 01 Fax HTEurope.info@hypertherm.com

Japan 81 05 5975 7387 Tel 81 05 5975 7376 Fax HTJapan.info@hypertherm.com

Hypertherm Brasil Ltda. 55 21 2278 6162 Tel 55 21 2578 0947 Fax HTBrasil.info@hypertherm.com